

PVC DOORS



WIŚNIEWSKI

GATES | WINDOWS | DOORS | FENCES

PVC DOORS

Intended use: PVC doors are intended for residential housing, industrial buildings, and public utility facilities.

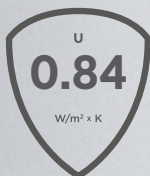

THERMAL INSULATION

The thermal transmittance factor of the PVC door is 0.84 W/m²K. The values apply to door size 1,100x2,180 [mm].



SAFETY

Unwelcome guests? Not in a house furnished with WIŚNIEWSKI PVC doors. Their precision-made structure ensures burglary resistance.



WARRANTY

The WIŚNIEWSKI PVC doors are covered by a 2-year warranty. This is just to be on the safe side, but we want you to know that you can count on us.



VERANDA DOORS



VERANDA DOOR CHARACTERISTICS

- Number of chambers in the frame: 5
- Installation depth: 70 [mm]
- Profile class: A
- Profile core: white, caramel, brown
- Gaskets around the circumference: 2
- Infill: glass unit 24-40 or infill 24 [mm]
- Maco B-TV drive gear, locked with a handle
- Lock cylinder with three keys
- Three surface hinges up to 120 kg
- Low aluminium threshold 20 mm

CROSS-SECTIONS AND VIEWS

Veranda door frames

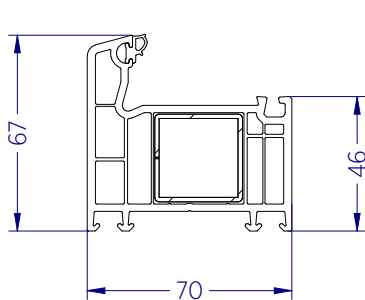

101.208

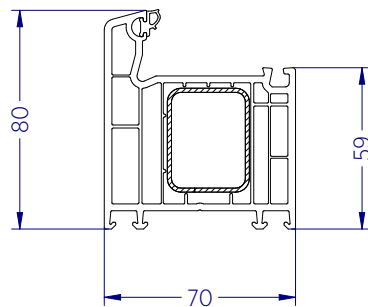

101.214

Veranda door leafs

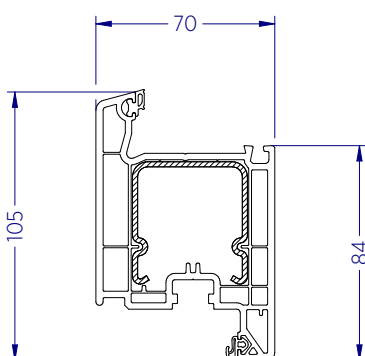

103.241

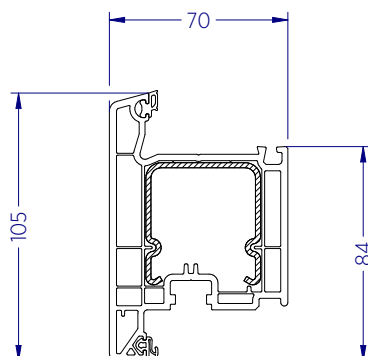

103.242



Post

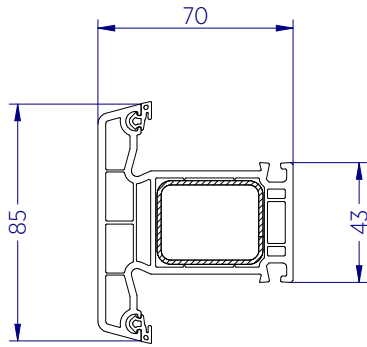

102.218

Threshold

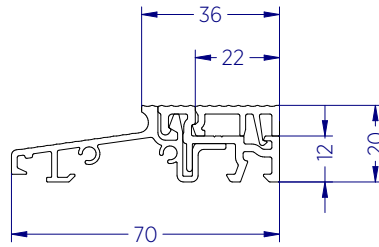

Low threshold
for inswing door

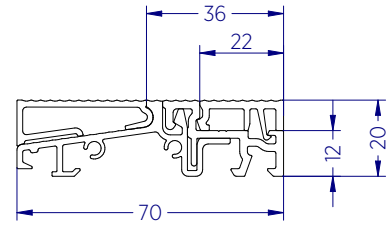

Low threshold
for outswing door

PVC PRIMO door with a low threshold, inswing

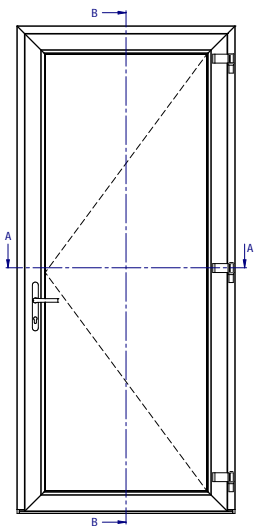

Vertical cross-section

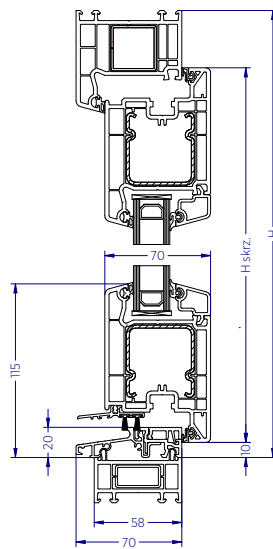

Horizontal cross-section

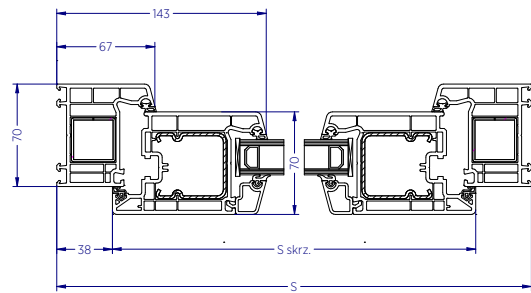

PVC PRIMO door with a high frame and low threshold, inswing

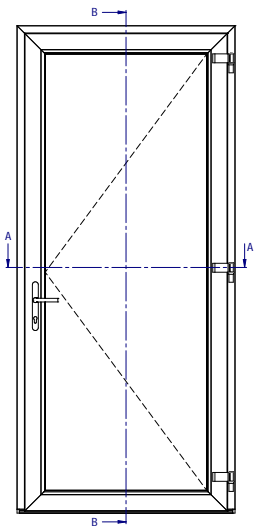

Vertical cross-section

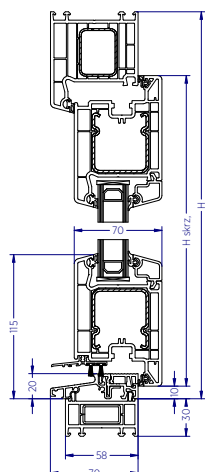

Horizontal cross-section

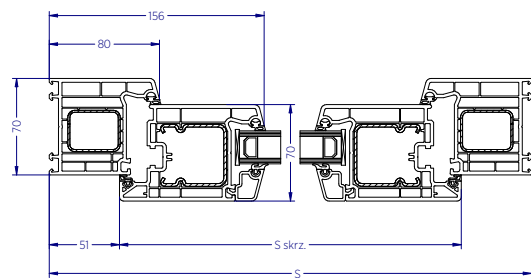



PVC PRIMO door, inswing. As seen from the inside

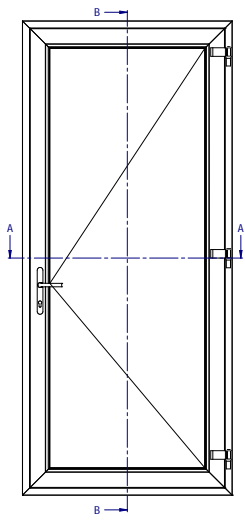

Vertical cross-section

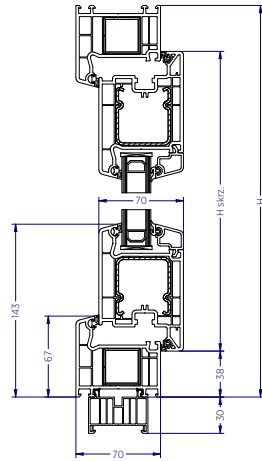

Horizontal cross-section

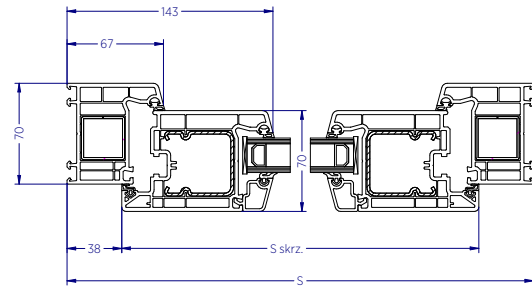

PVC PRIMO door, inswing, with a sidelight

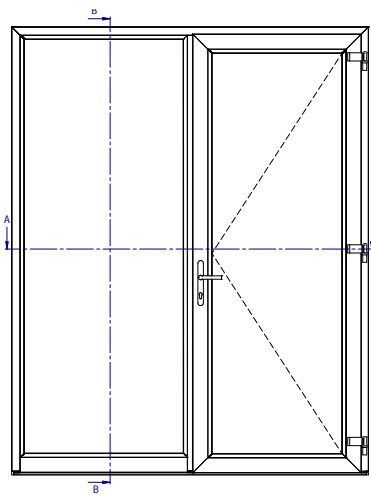

Vertical cross-section

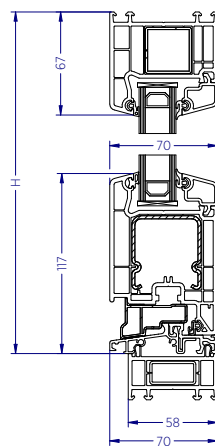

Horizontal cross-section

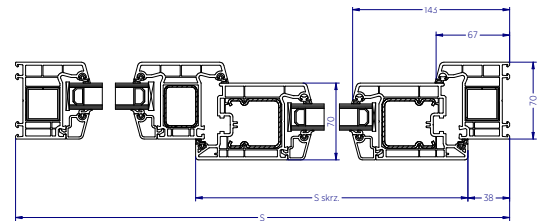

PVC PRIMO door, high frame, inswing, with a sidelight

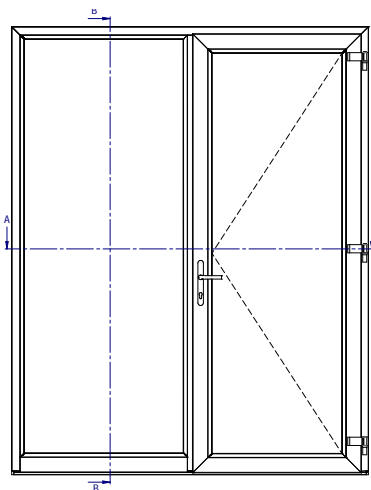

Vertical cross-section

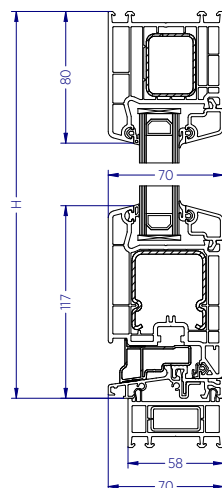

Horizontal cross-section

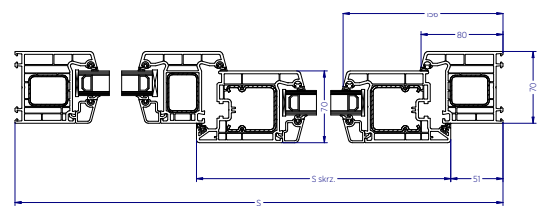



PVC PRIMO door with a low threshold, outswing

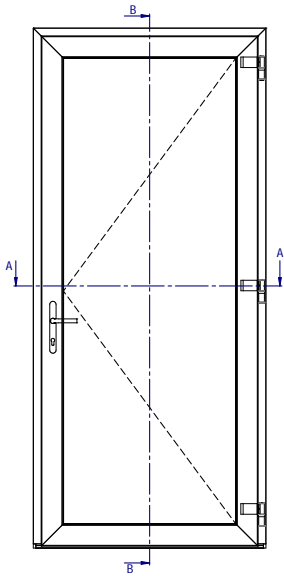

Vertical cross-section

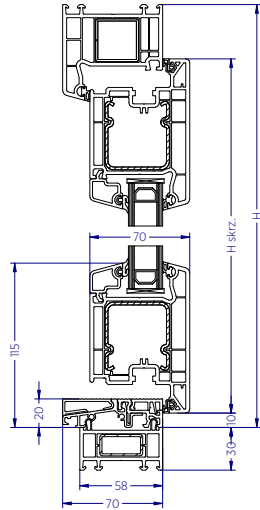

Horizontal cross-section

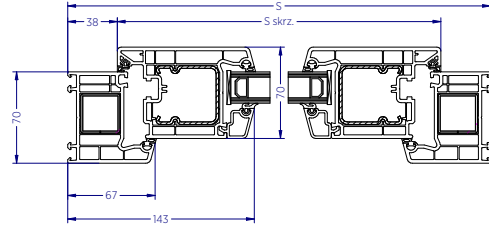

PVC PRIMO door with a high frame and low threshold, outswing

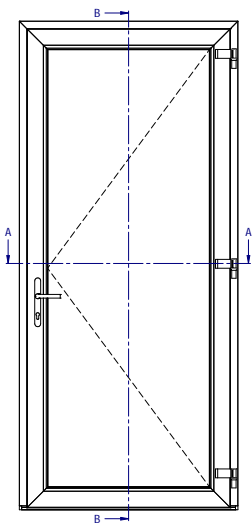

Vertical cross-section

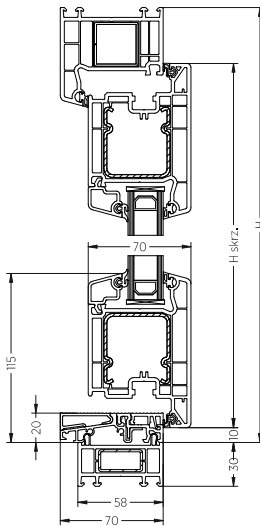

Horizontal cross-section

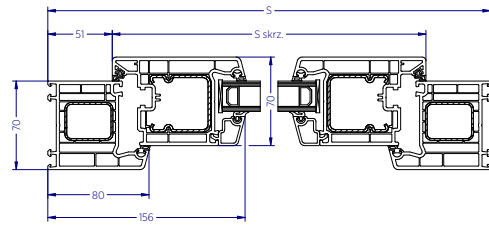



Double-leaf veranda door with a moving post and two handles, outswing

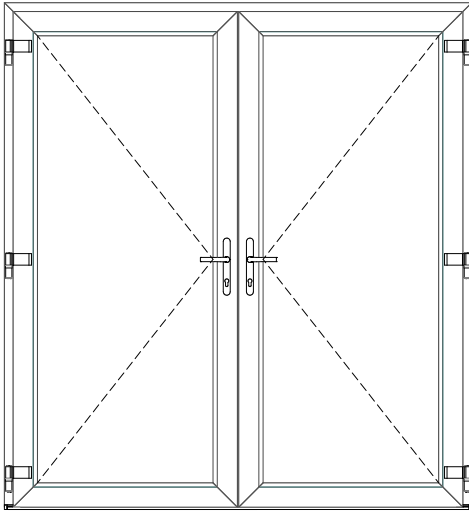

Vertical cross-section

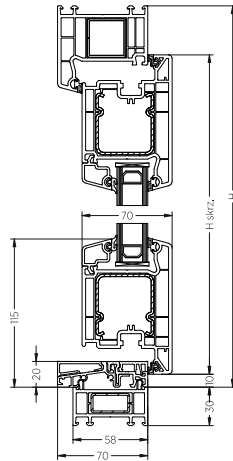

Horizontal cross-section

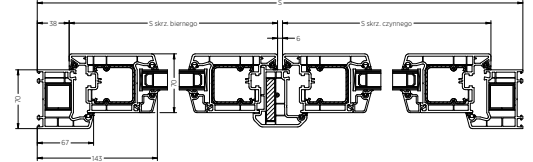

HARDWARE AND ACCESSORIES

Hinge spacing

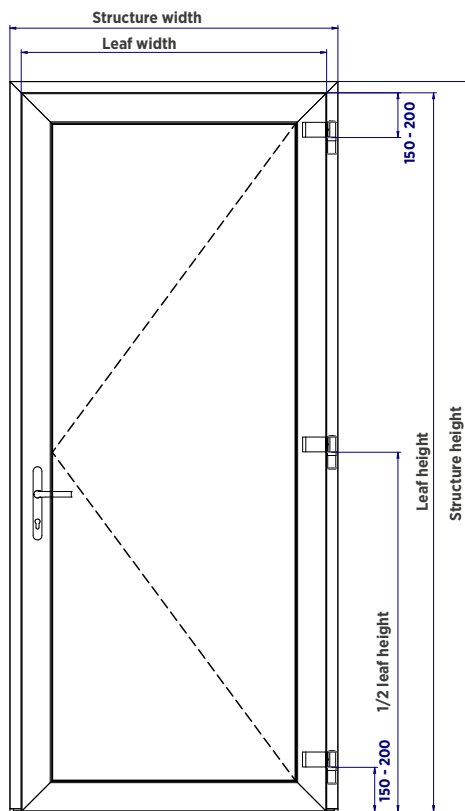

Handle

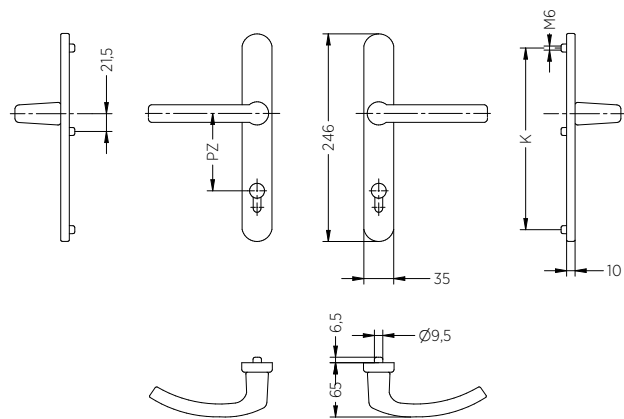

Available colours:

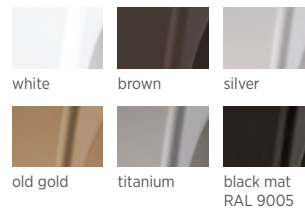



Available hinge colours

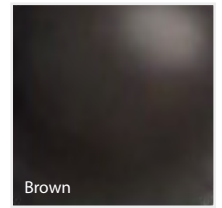
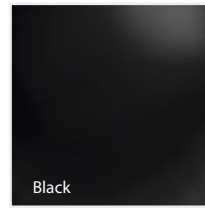
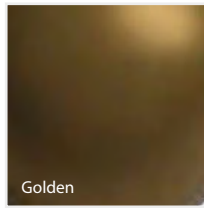
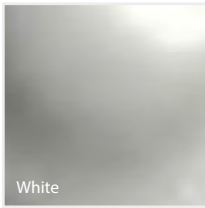

Handle height

For a door with a low threshold

For a door with a frame threshold 101.208

For a door with a frame threshold 101.241

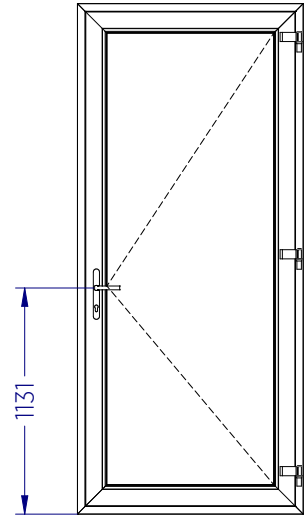
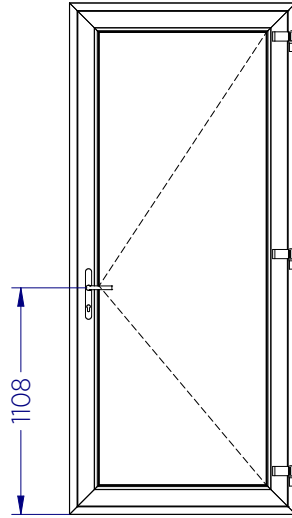
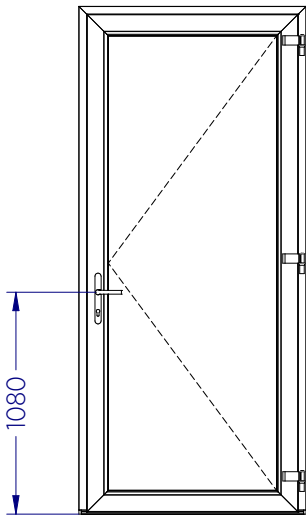

Hardware and striker placement

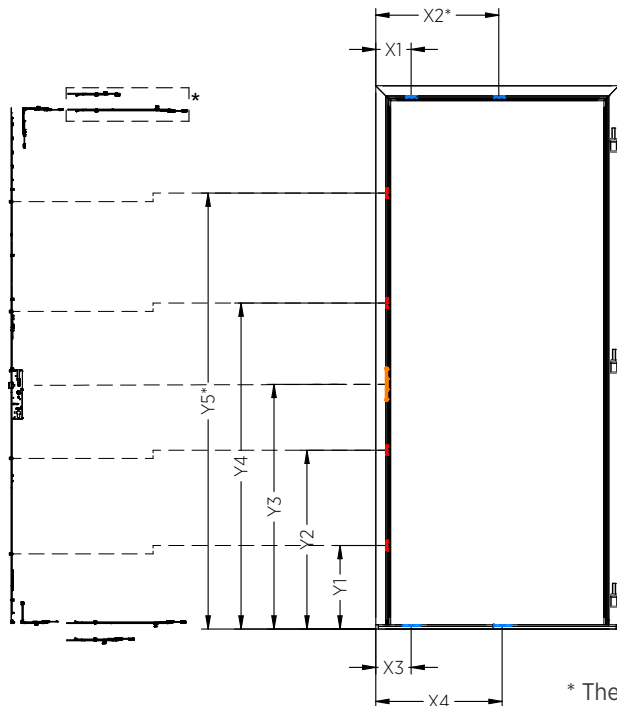

* The centre top locking in the Security version



Structure with a low threshold												
Frame index	Structure height	Number of locking points		Parameter								
		Vertical	Horizontal	X1	X2	X3	X4 *	Y1	Y2	Y3	Y4	Y5
101.208	< 2,289	4	3 / 4*	161.5	575	161.5	575	380	814	1,080	1,483	-
	> 2,289	5	3 / 4*	161.5	575	161.5	575	380	814	1,080	1,483	1,983
101.214	< 2,271	4	3 / 4*	174.5	588	174.5	588	380	814	1,080	1,483	-
	> 2,271	5	3 / 4*	174.5	588	174.5	588	380	814	1,080	1,483	1,983

Structure with a frame profile threshold												
Frame index	Structure height	Number of locking points		Parameter								
		Vertical	Horizontal	X1	X2	X3	X4 *	Y1	Y2	Y3	Y4	Y5
101.208	< 2,317	4	3 / 4*	161.5	575	161.5	575	408	842	1,108	1,511	-
	> 2,317	5	3 / 4*	161.5	575	161.5	575	408	842	1,108	1,511	2,011
101.214	< 2,343	4	3 / 4*	174.5	588	174.5	588	431	865	1,131	1,534	-
	> 2,343	5	3 / 4*	174.5	588	174.5	588	431	865	1,131	1,534	2,034

STRUCTURAL LIMITATIONS

Maximum leaf dimensions

	Veranda leaf profile		Single-leaf veranda door	
			White	Colour
Maximum surface area of the leaf	WIDE leaf 103.241	Leaf width up to 1,000 [mm]	2.4 [m ²]	
	WIDE leaf 103.242			
	WIDE leaf 103.241	Leaf width from 1,000 [mm]	2.31 [m ²]	
	WIDE leaf 103.242			
Maximum width of the leaf	WIDE leaf 103.241		1,124 [mm]	
	WIDE leaf 103.242			
Maximum height of the leaf	WIDE leaf 103.241		2,402 [mm]	
	WIDE leaf 103.242			
Maximum total weight of the leaf with glass	STANDARD leaf 103.232	Leaf width up to 1,000 [mm]	120 [kg]	
	WIDE leaf 103.242			
	WIDE leaf 103.241	Leaf width from 1,000 [mm]	100 [kg]	
	WIDE leaf 103.242			
Leaf width to height ratio	-		< 1.6	



Minimum leaf dimensions

	Width	Height
Minimum dimension	674 [mm]	1,741 [mm]

Minimum dimensions of a single-leaf structure

Parameter	Width	Height
Minimum dimension for a structure with a low threshold	750 [mm]	1,789 [mm]
Minimum dimension for a structure with a frame profile threshold	750 [mm]	1,817 [mm]
Minimum dimension for a structure with a high frame and a low threshold	776 [mm]	1,802 [mm]
Minimum dimension for a structure with a high frame and a frame profile threshold	776 [mm]	1,843 [mm]

Minimum dimensions of a symmetrical structure with a sidelight

Parameter	Width	Height
Minimum dimension for a structure with a low threshold	1,451 [mm]	1,789 [mm]
Minimum dimension for a structure with a high frame	1,477 [mm]	1,802 [mm]

Maximum dimensions of a symmetrical structure with a sidelight

Parameter	Width	Height
Maximum dimension for a structure – standard frame	2,351 [mm]	2,450 [mm]
Maximum dimension for a structure – high frame	2,377 [mm]	2,463 [mm]
Maximum surface area of the window structure in a single frame	8.00 [m ²]	-

Maximum dimensions of an asymmetrical structure with a sidelight

Parameter	Value	Limitations
Maximum surface area of the window structure in a single frame	8.00 [m ²]	-
Maximum width of the structure	4,200 [mm]	film coating: NO (white)
	4,000 [mm]	film coating: YES
Maximum height of the structure – standard frame	2,450 [mm]	-
Maximum height of the structure – high frame	2,463 [mm]	-



STRUCTURAL LIMITATIONS FOR DOUBLE-LEAF VERANDA DOORS

Minimum dimensions of the leaf structure

Structure type	Profile system	Frame profile	Double-leaf PVC entrance door	
			Width	Height
Structure with a low threshold	Perfectline 70	Frame 101.208	1,430	1,789
		Frame 101.214	1,456	1,802

Maximum dimensions of the leaf structure

Structure type	Profile system	Frame profile	Double-leaf PVC entrance door	
			Width	Height
Structure with a low threshold	Perfectline 70	Frame 101.208	1,682	2,450
		Frame 101.214	1,708	2,463



ORDERING DIMENSIONS

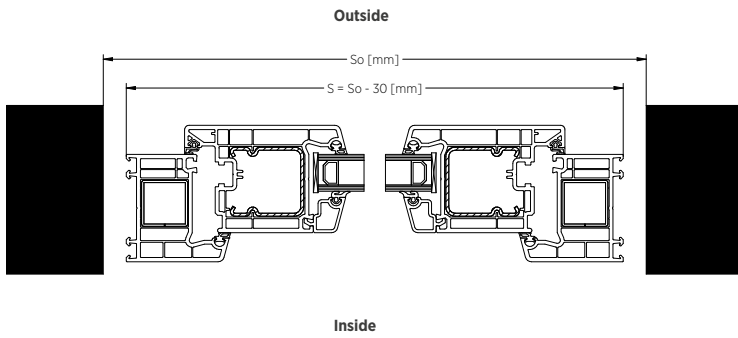
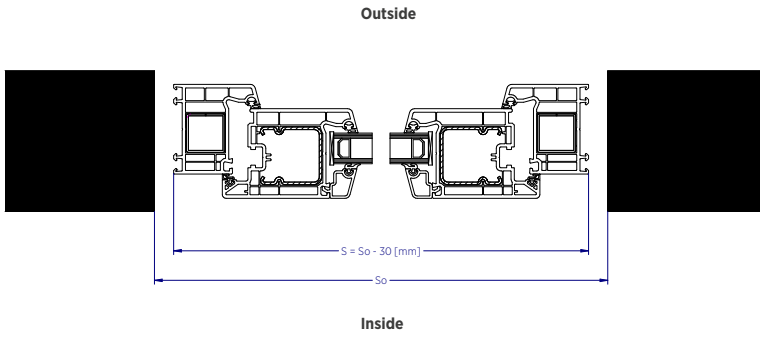
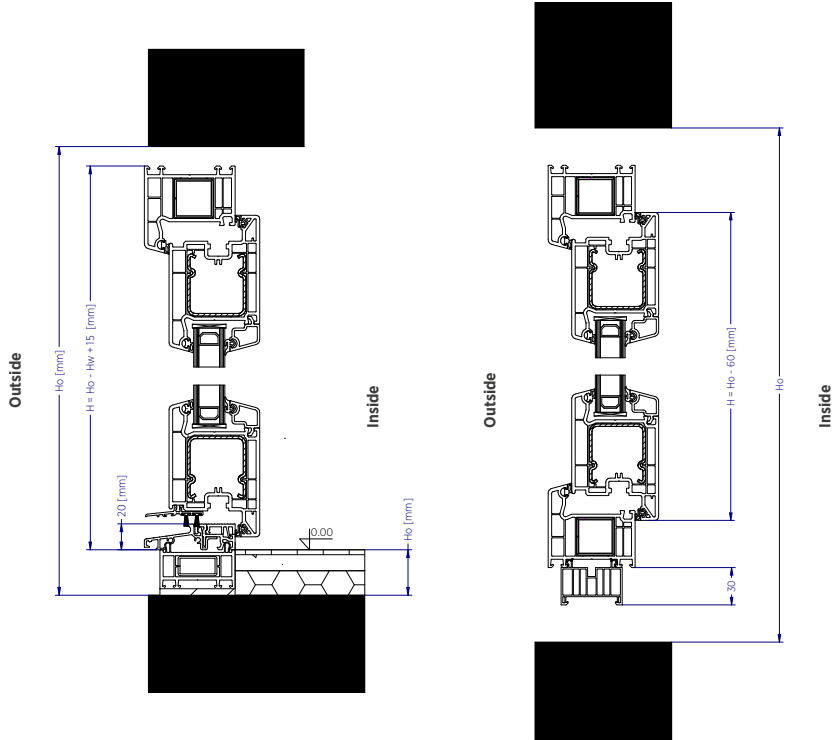



ENTRANCE DOORS

CHARACTERISTICS OF THE **PRIMO 70** ENTRANCE DOOR



- Number of chambers in the frame: 5
- Installation depth: 70 [mm]
- Profile class: A
- Profile core: white, caramel, brown
- Gaskets around the circumference: 2
- Infill: glass unit 24-40 or infill 24 [mm]
- Siegenia HOOK DRIVE GEAR – two automatically locked bolts, two hooks locked with a key
- Lock cylinder with three keys
- Three surface hinges
- Low aluminium threshold 20 [mm]

CROSS-SECTIONS AND VIEWS

Entrance door frames

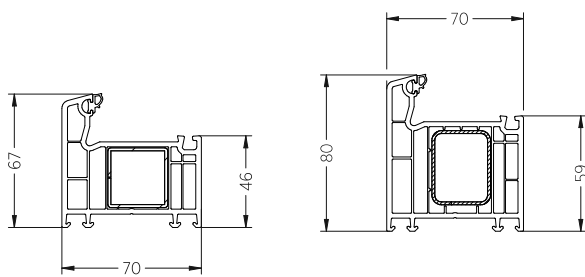

Standard frame

101.214

Entrance door leaves

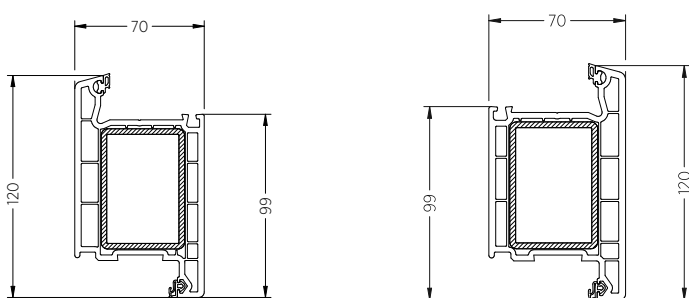

105.232

105.233



Posts

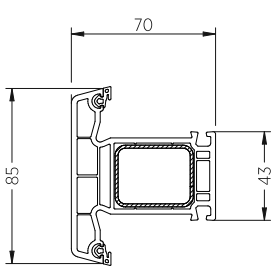

102.218

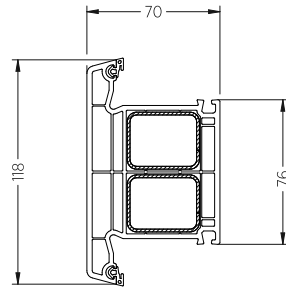

102.238

Leaf cross rail

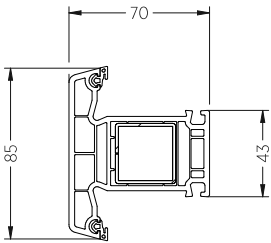

102.214

Threshold

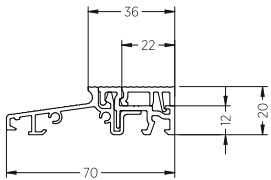

Low threshold for inswing door

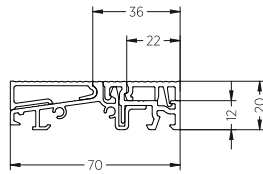

Low threshold with a cover for outswing door

PRIMO 70 PVC door with a low threshold, inswing

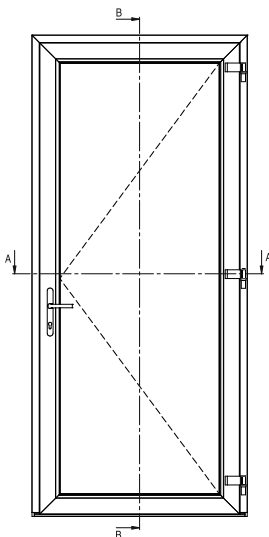

Vertical cross-section

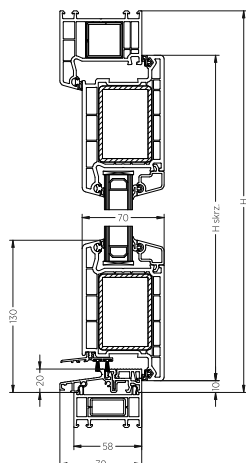

Horizontal cross-section

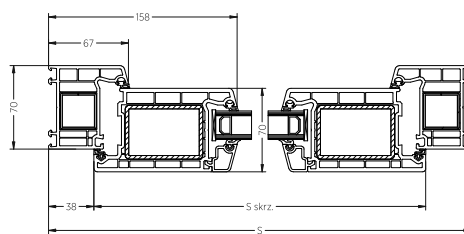



PRIMO 70 PVC door with a high frame and low threshold, inswing

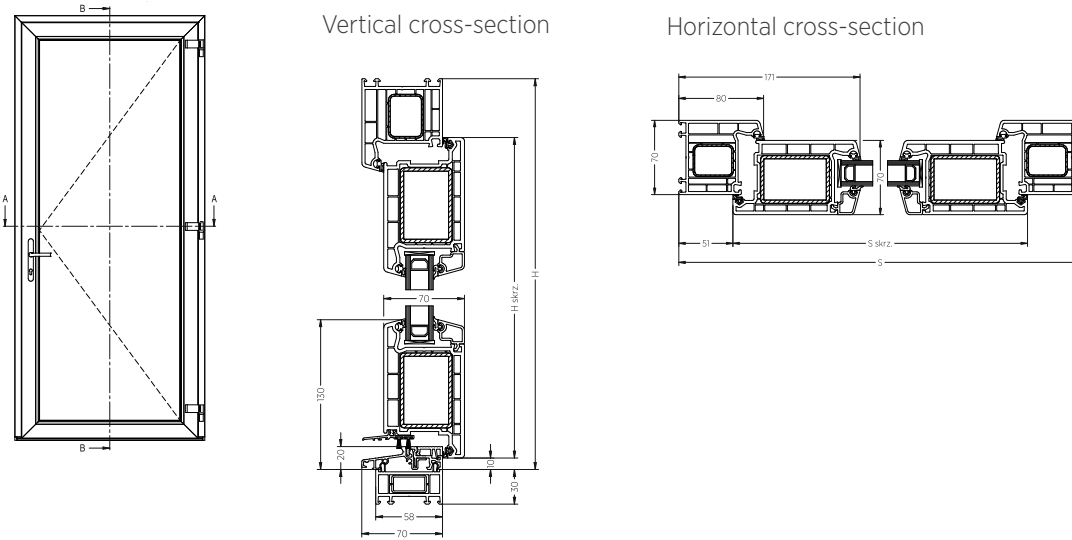

PRIMO 70 PVC door, inswing. As seen from the inside

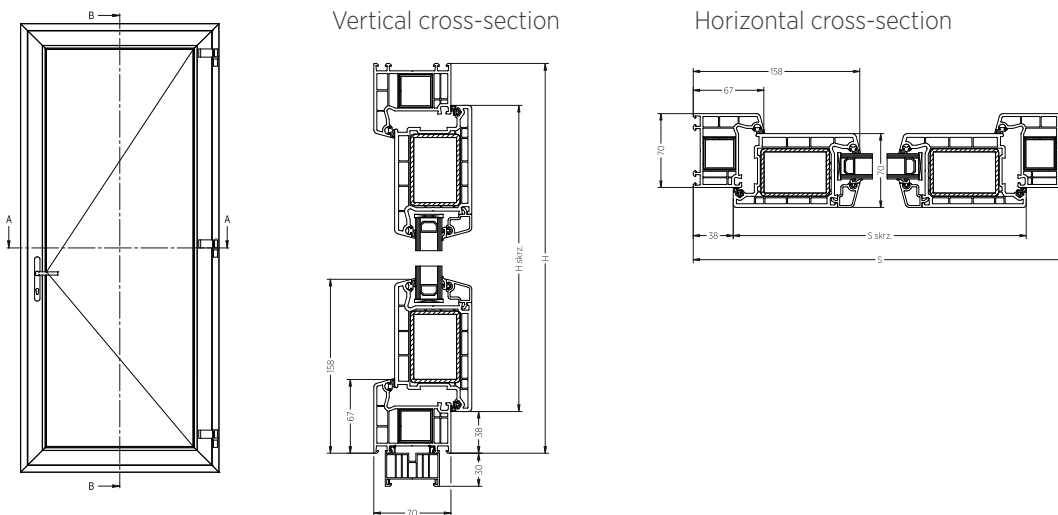

PRIMO 70 PVC door with a high frame, inswing

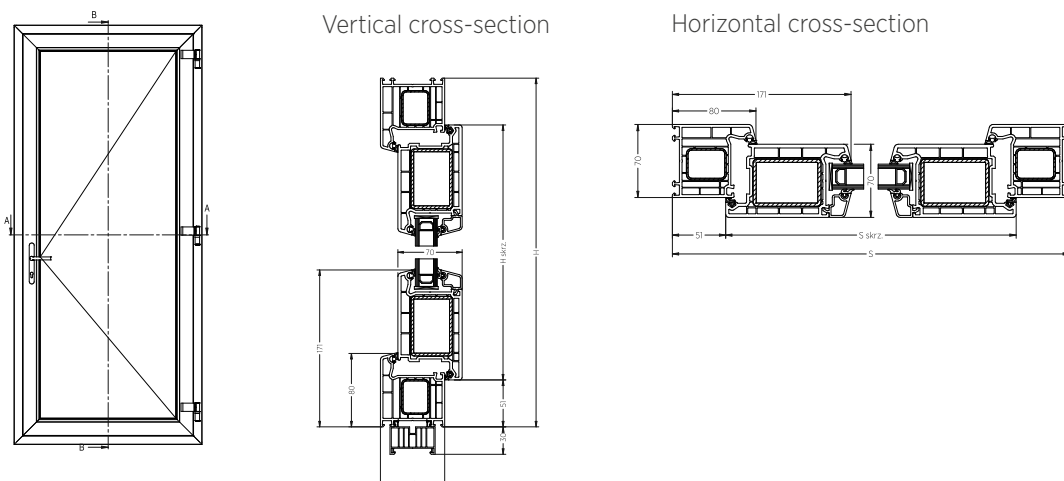



PRIMO 70 PVC door, inswing, with a sidelight

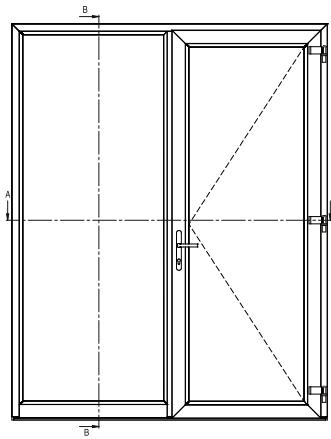

Vertical cross-section

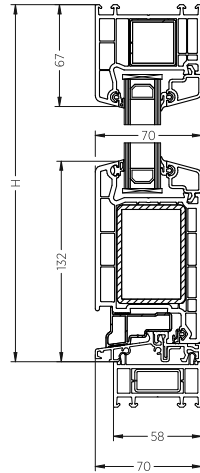

Horizontal cross-section

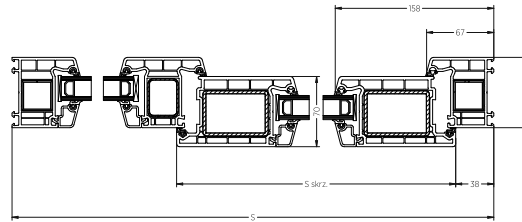

PRIMO 70 PVC door, high frame, inswing, with a sidelight

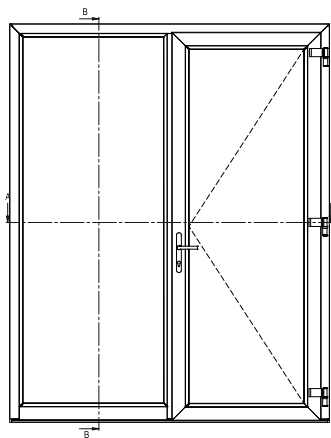

Vertical cross-section

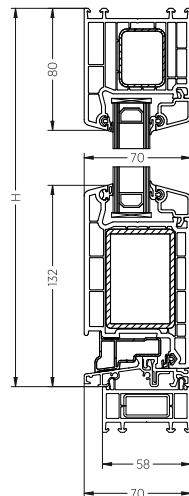

Horizontal cross-section

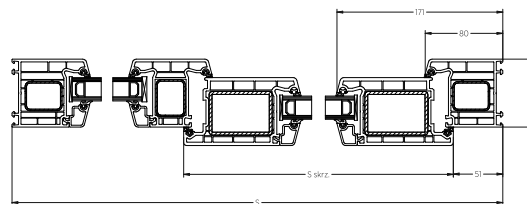

PRIMO 70 PVC door with a low threshold, outswing

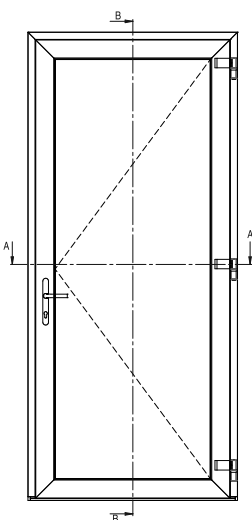

Vertical cross-section

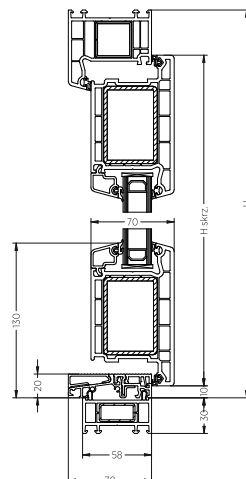

Horizontal cross-section

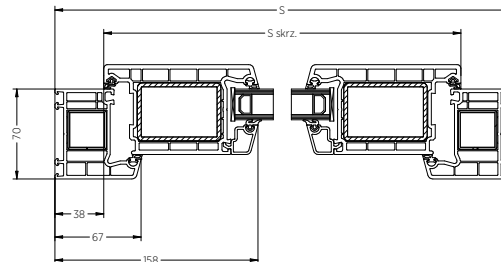



PRIMO 70 PVC door with a high frame and low threshold, outswing

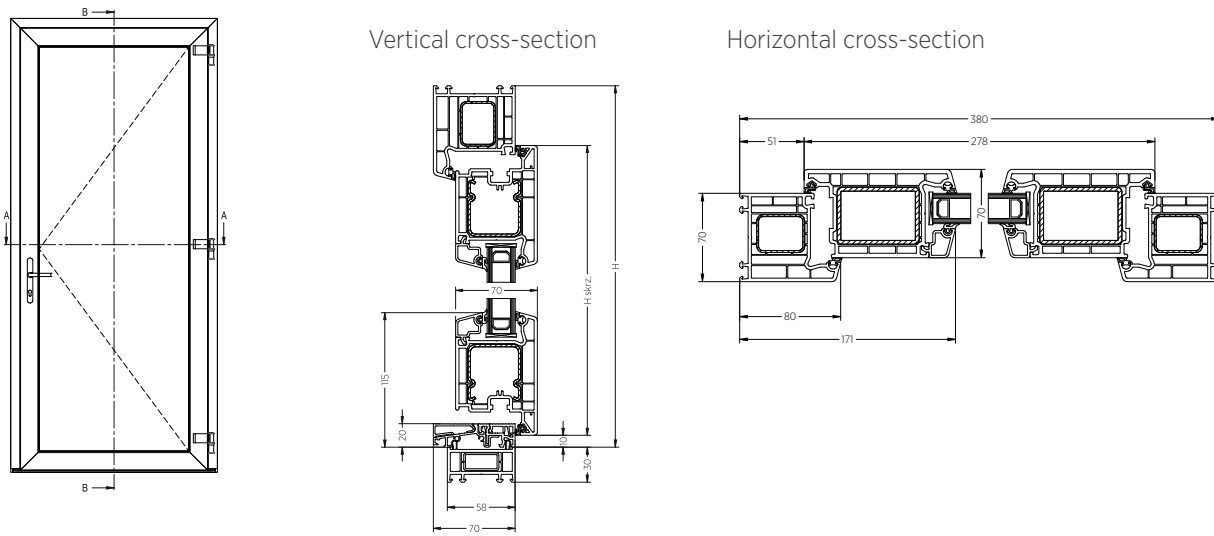

HARDWARE AND AVAILABLE ACCESSORIES

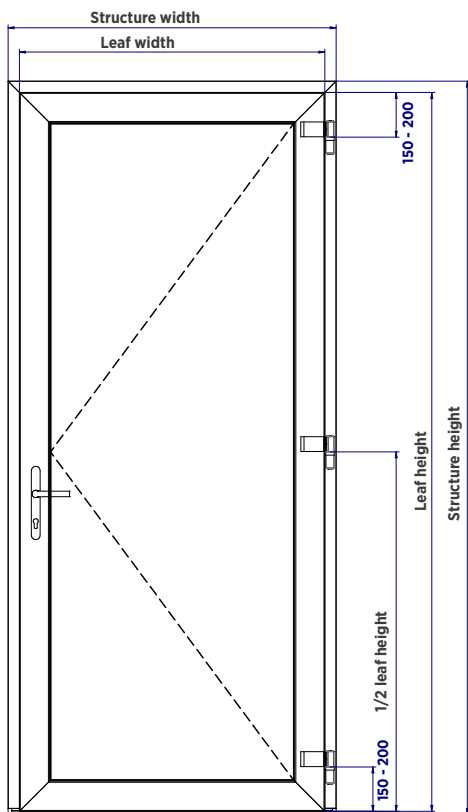

Available hinge colours

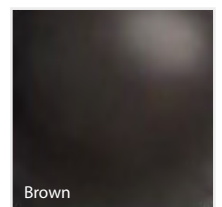
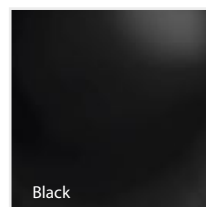
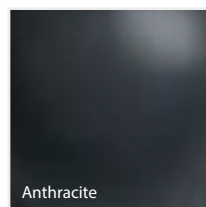
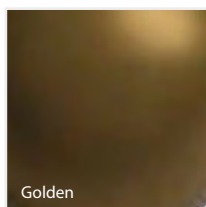
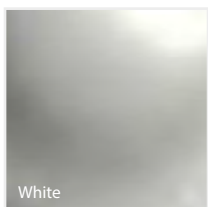



Handle

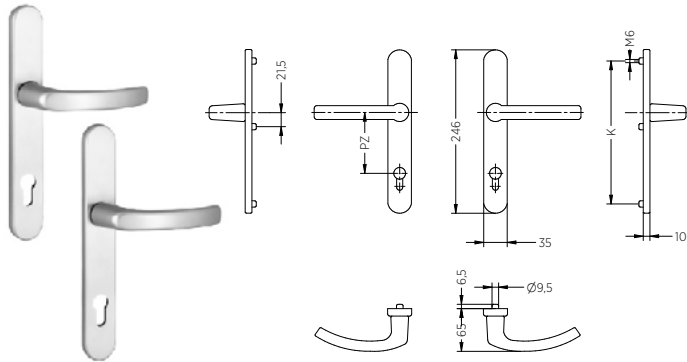

Handle-knob

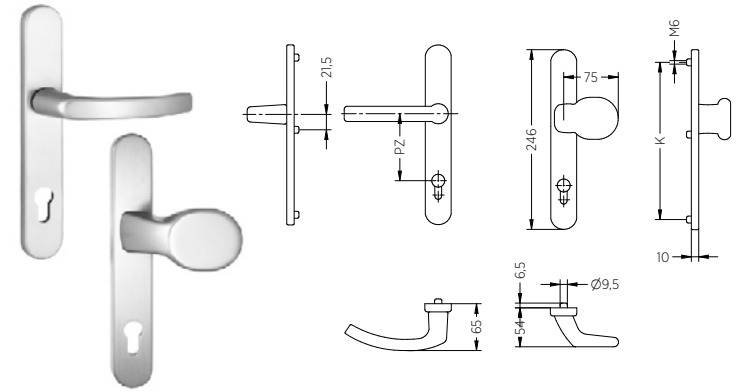

Available colours:

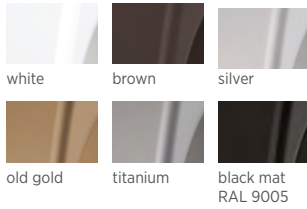

Available colours:

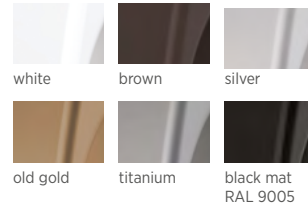

Handle height

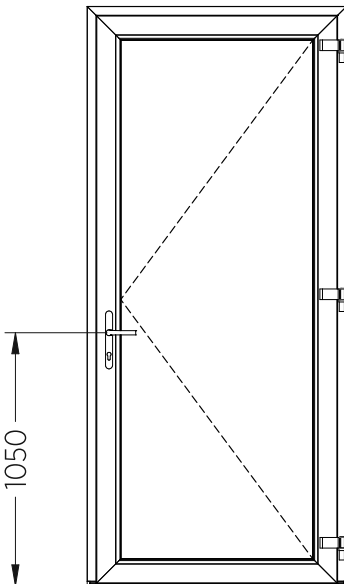

Handle height in a door with a low threshold

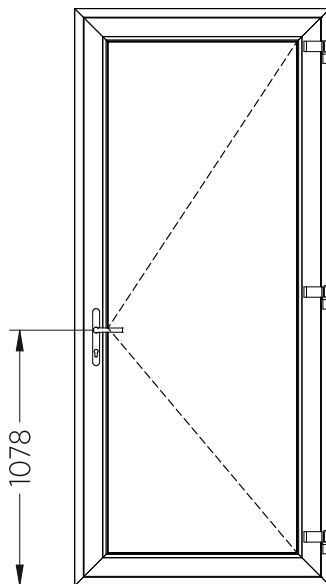

Handle height in a door with a frame profile threshold 101.208

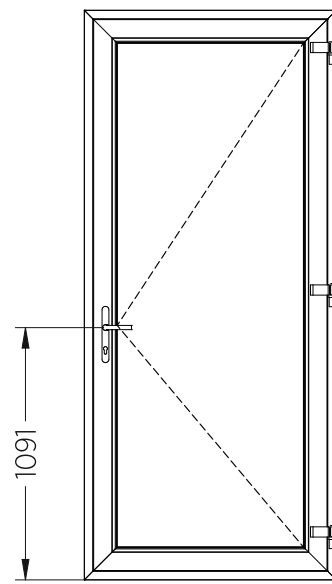

Handle height in a door with a frame profile threshold 101.214



Hardware and striker placement

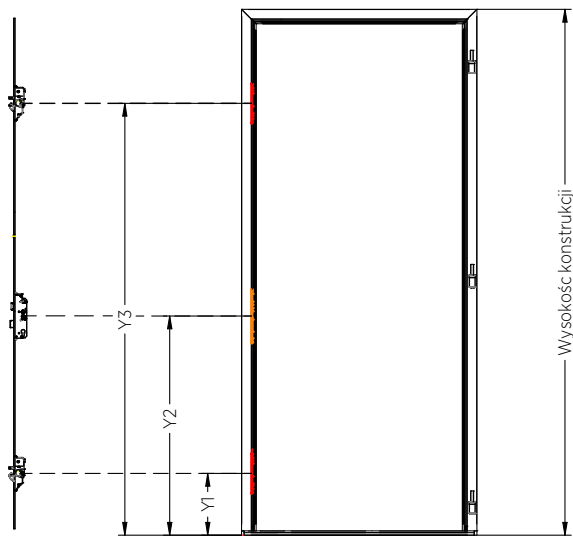

Structure with a low threshold				
Frame index	Height structure	Parameter		
		Y1	Y2	Y3
101.208	< 2,258	290	1,030	1,780
	> 2,258	290	1,030	2,030
101.214	< 2,271	290	1,030	1,780
	> 2,271	290	1,030	2,030

Structure with a frame profile threshold				
Frame index	Height structure	Parameter		
		Y1	Y2	Y3
101.208	< 2,286	318	1,058	1,808
	> 2,286	318	1,058	2,058
101.214	< 2,312	331	1,071	1,821
	> 2,312	331	1,071	2,071

Locking

Turning the key twice extends the top lock bolt and hook bolts

Unlocking

Turning the key twice retracts the top lock bolt and hook bolts In the last phase, the main lock latching deadbolt and automatic bolts retract

ORDERING DIMENSIONS

Inswing

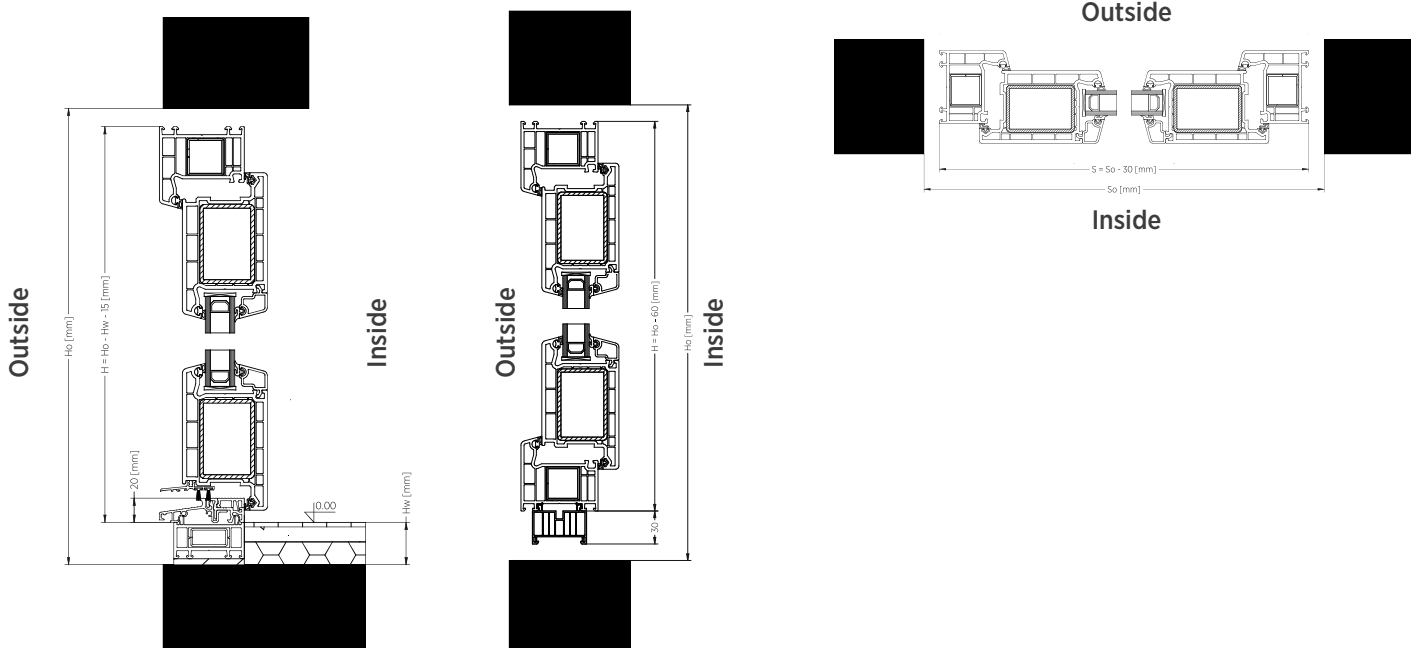



Outswing

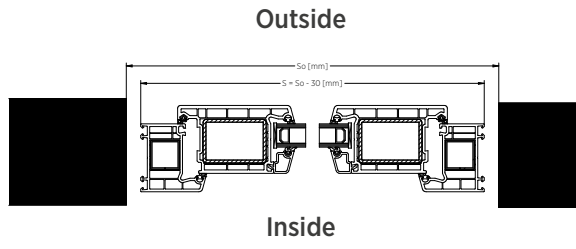
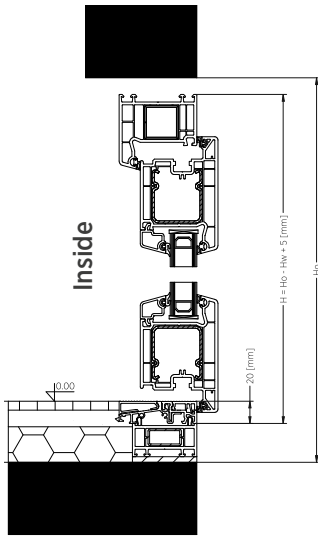



CHARACTERISTICS OF THE **PRIMO 82** ENTRANCE DOOR



- Number of chambers in the frame: 7
- Installation depth: 82 [mm]
- Profile class: A
- Profile core: white, caramel, brown, anthracite
- Gaskets around the circumference: 3
- Infill: glass unit 24-52 or infill 24 and 48 [mm]
- Siegenia HOOK DRIVE GEAR – two automatically locked bolts, two hooks locked with a key
- Lock cylinder with three keys
- Three surface hinges
- Low aluminium threshold 20 [mm]

CROSS-SECTIONS AND VIEWS

Entrance door frames

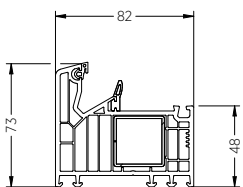

Standard frame

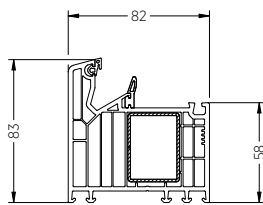

High frame

Entrance door leaves

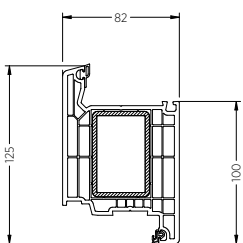

105.380

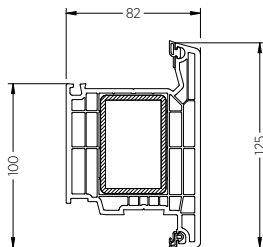

105.381



Posts

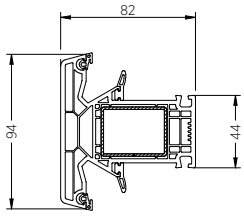

102.310

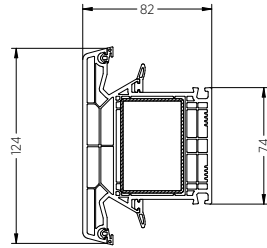

102.311

Leaf cross rail

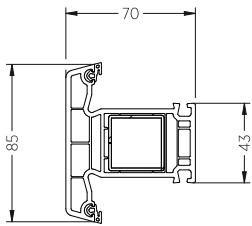

102.214

Threshold

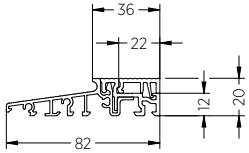

Low threshold for inswing door

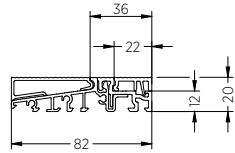

Low threshold with a cover for outswing door

PRIMO 82 PVC door with a low threshold, inswing

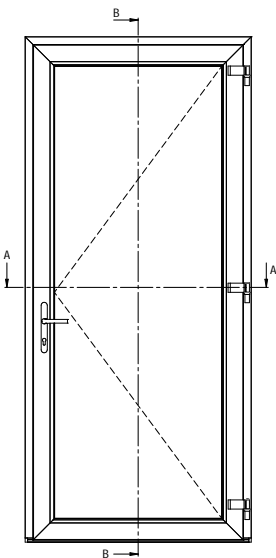

Vertical cross-section

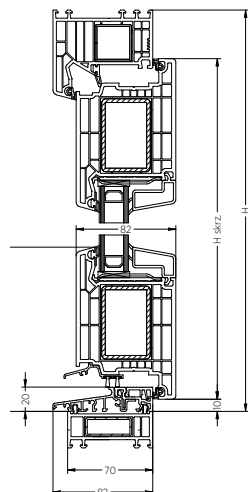

Horizontal cross-section

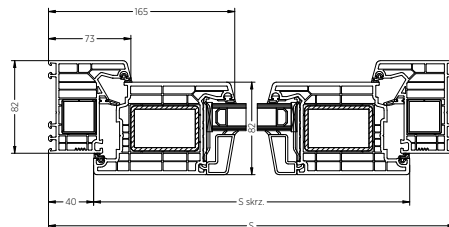



PRIMO 82 PVC door with a high frame and low threshold, inswing

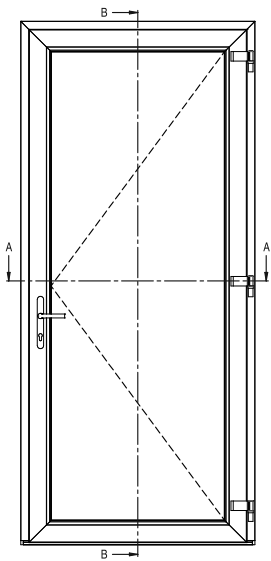

Vertical cross-section

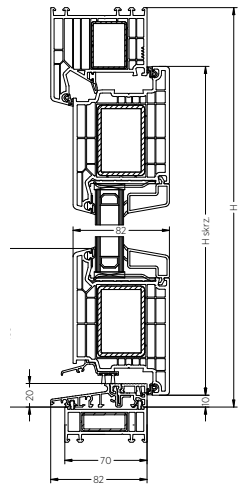

Horizontal cross-section

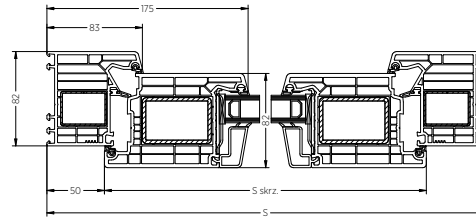

PRIMO 82 PVC door, inswing. As seen from the inside

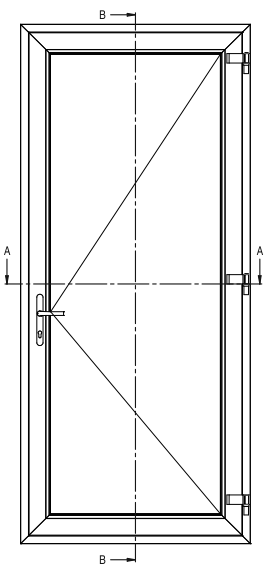

Vertical cross-section

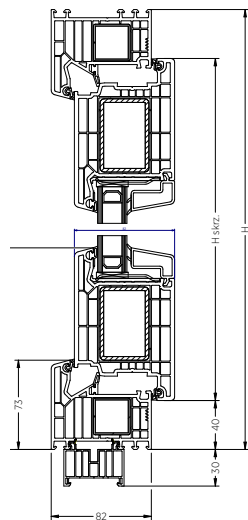

Horizontal cross-section

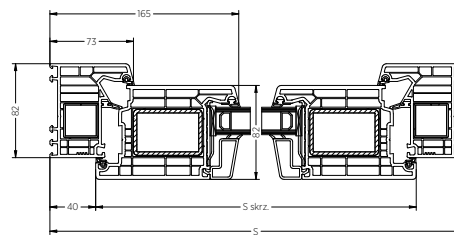

PRIMO 82 PVC door with a high frame, inswing

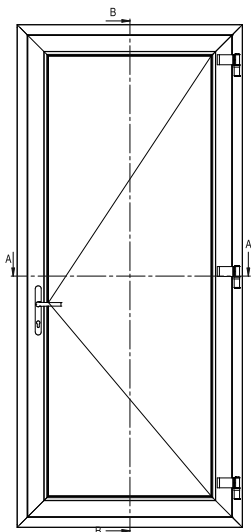

Vertical cross-section

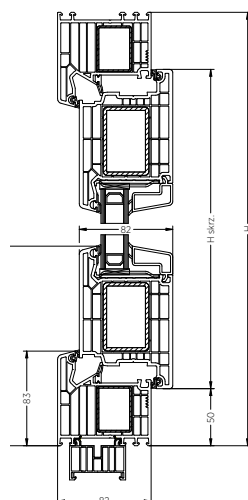

Horizontal cross-section

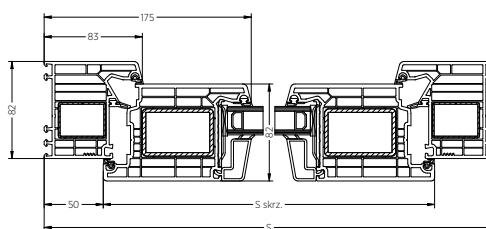



PRIMO 82 PVC door, inswing, with a sidelight

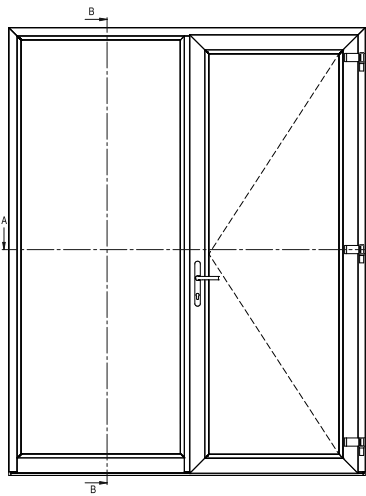

Vertical cross-section

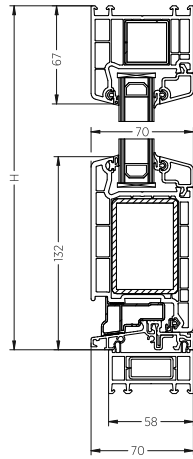

Horizontal cross-section

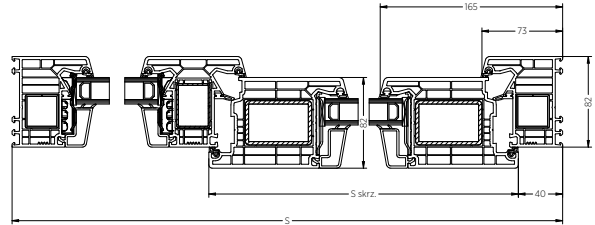

PRIMO 82 PVC door, high frame, inswing, with a sidelight

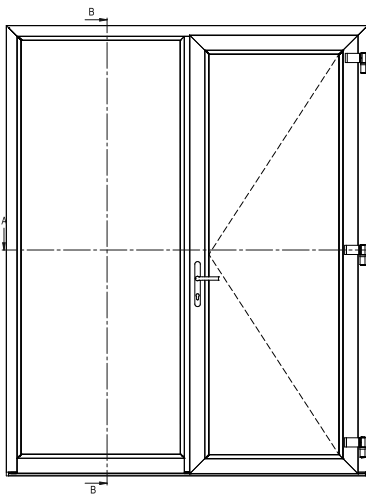

Vertical cross-section

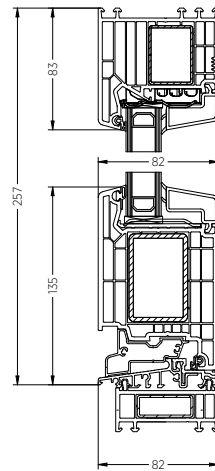

Horizontal cross-section

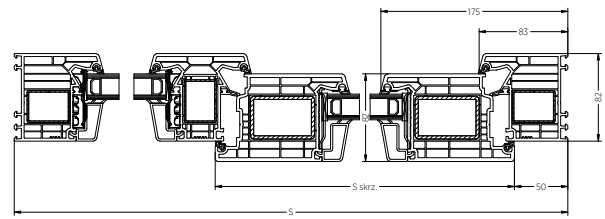

PRIMO 82 PVC door with a low threshold, outswing

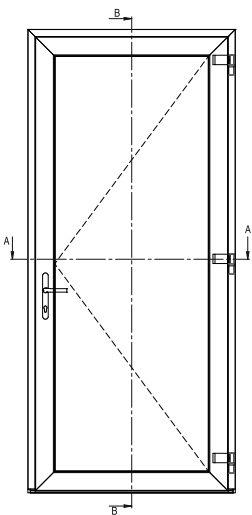

Vertical cross-section

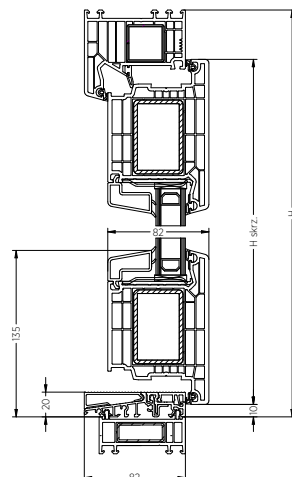

Horizontal cross-section

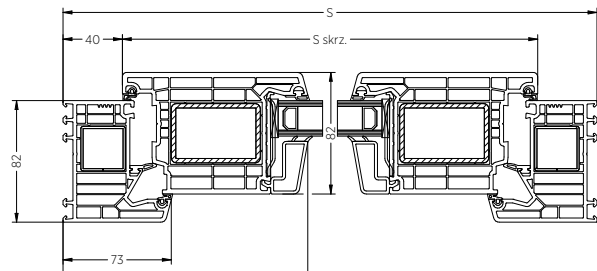



PRIMO 82 PVC door with a high frame and low threshold, outswing

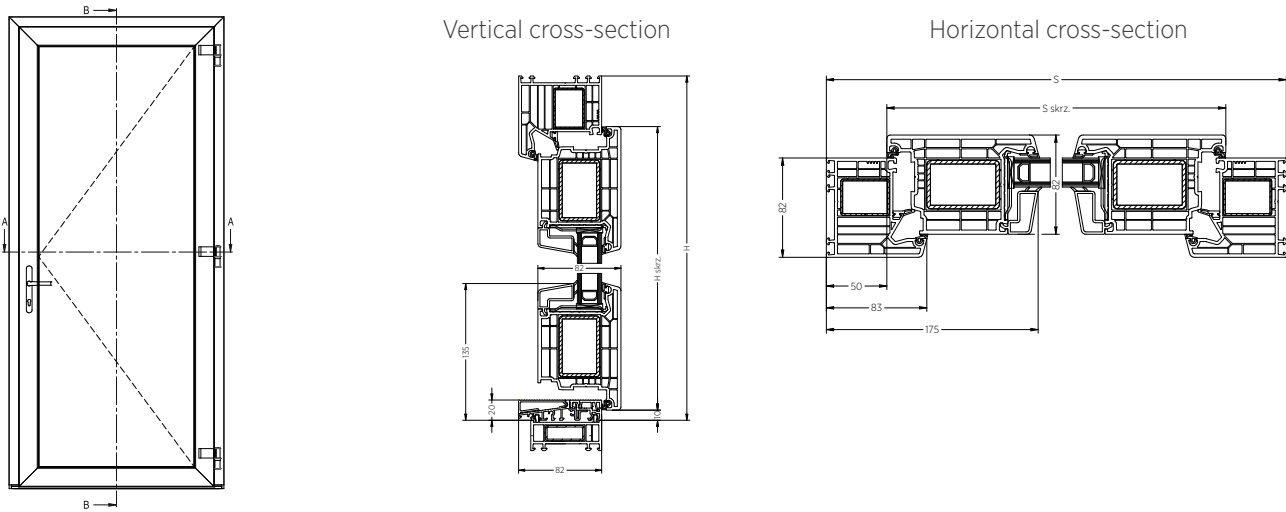

HARDWARE AND AVAILABLE ACCESSORIES

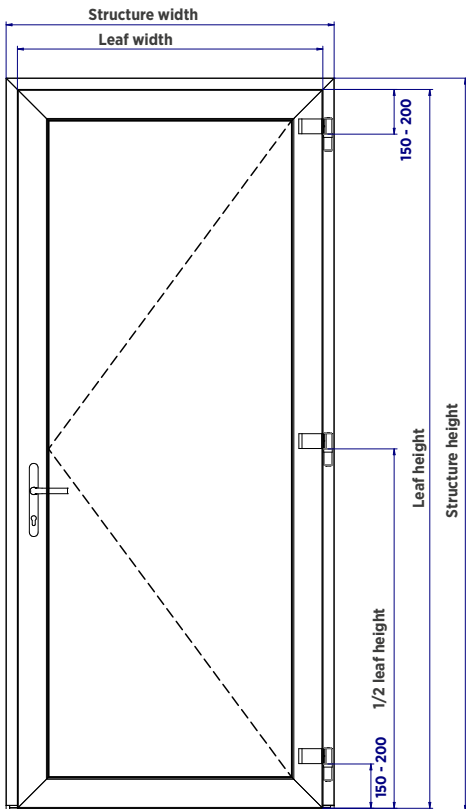

Available hinge colours

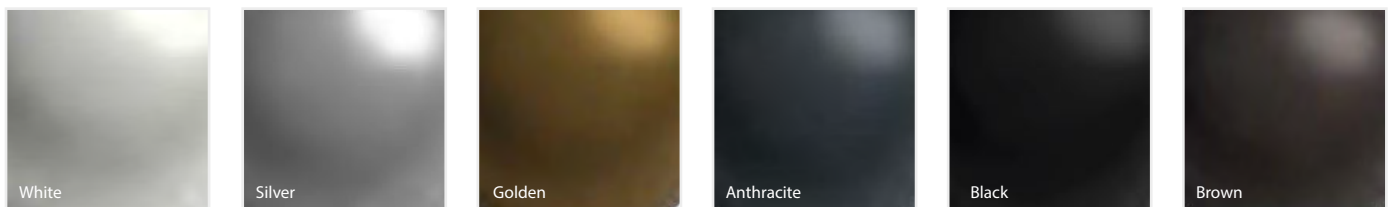



Handle

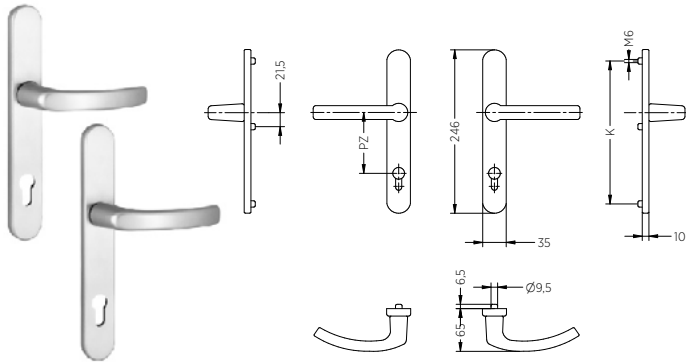

Handle-knob

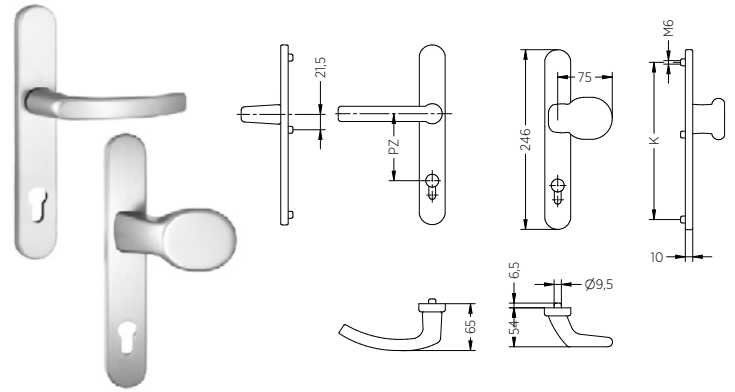

Available colours:

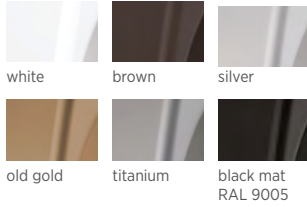

Available colours:

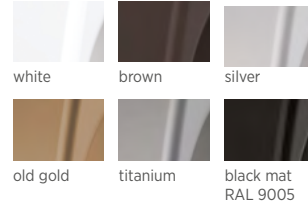

Handle height

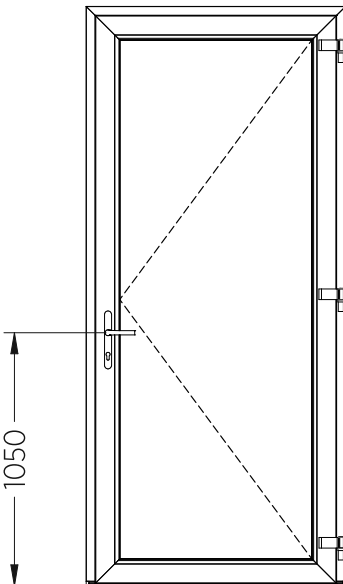

Handle height in a door with a low threshold

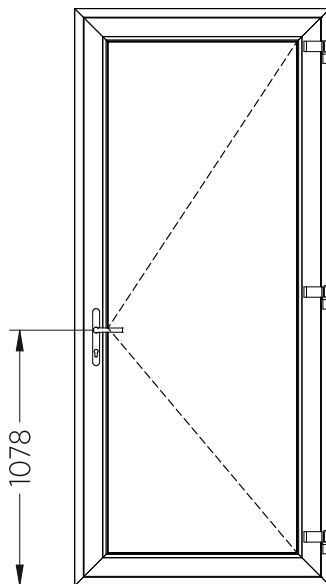

Handle height in a door with a frame profile threshold 101.208

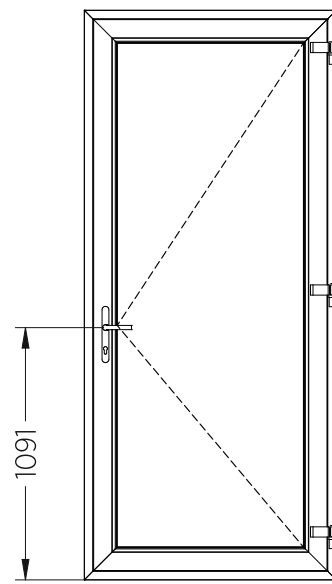

Handle height in a door with a frame profile threshold 101.214



Hardware and striker placement

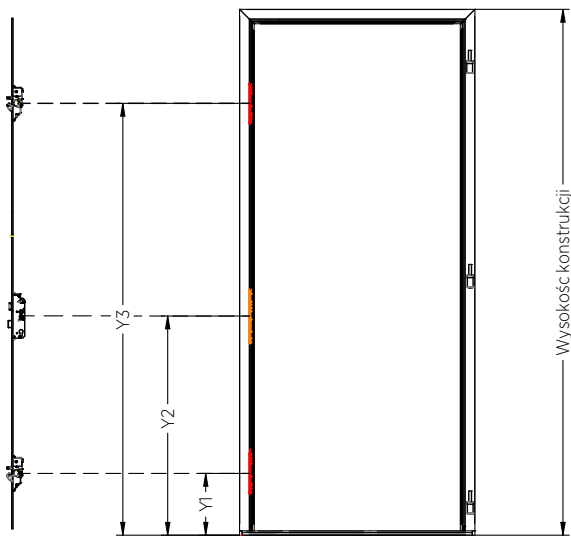

Structure with a low threshold				
Frame index	Height structure	Parameter		
		Y1	Y2	Y3
101.290	< 2,260	290	1,030	1,780
	> 2,260	290	1,030	2,030
101.291	< 2,270	290	1,030	1,780
	> 2,270	290	1,030	2,030

Structure with a frame profile threshold				
Frame index	Height structure	Parameter		
		Y1	Y2	Y3
101.290	< 2,260	320	1,060	1,810
	> 2,260	320	1,060	2,060
101.291	< 2,270	330	1,070	1,820
	> 2,270	330	1,070	2,070

Locking

Turning the key twice extends the top lock bolt and hook bolts

Unlocking

Turning the key twice retracts the top lock bolt and hook bolts In the last phase, the main lock latching deadbolt and automatic bolts retract

Inswing

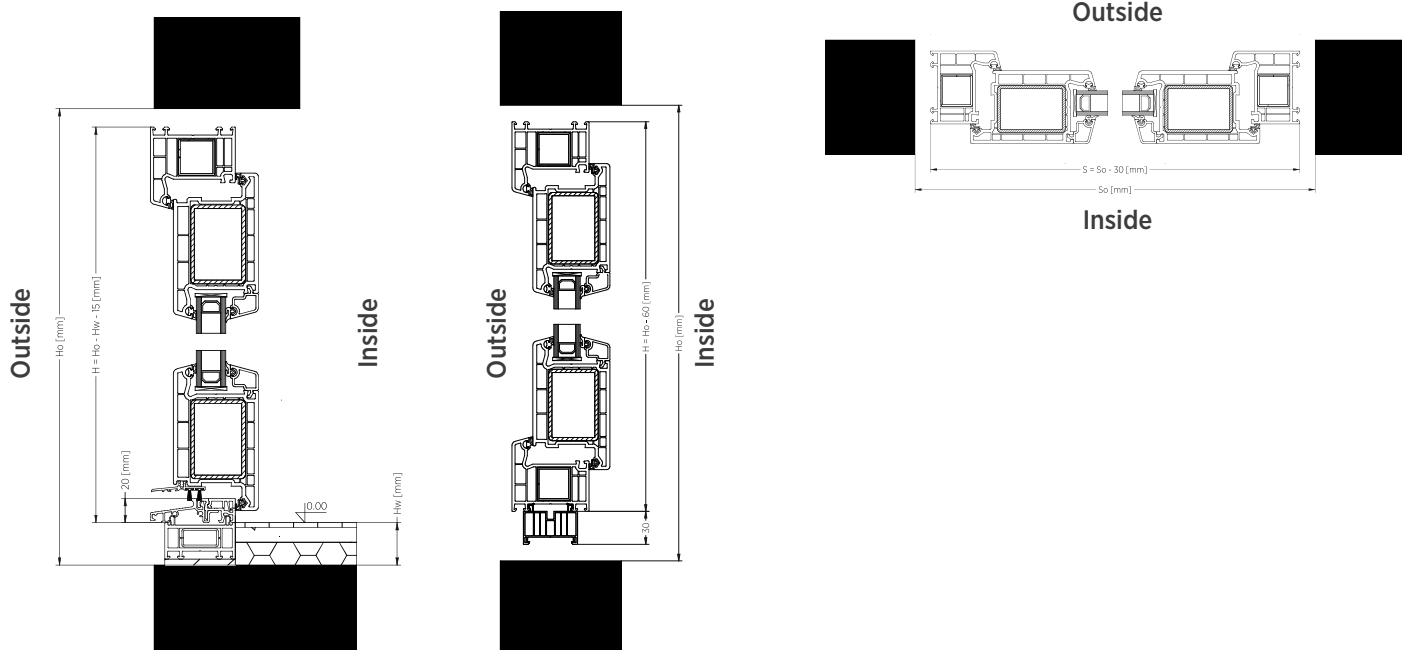



Outswing

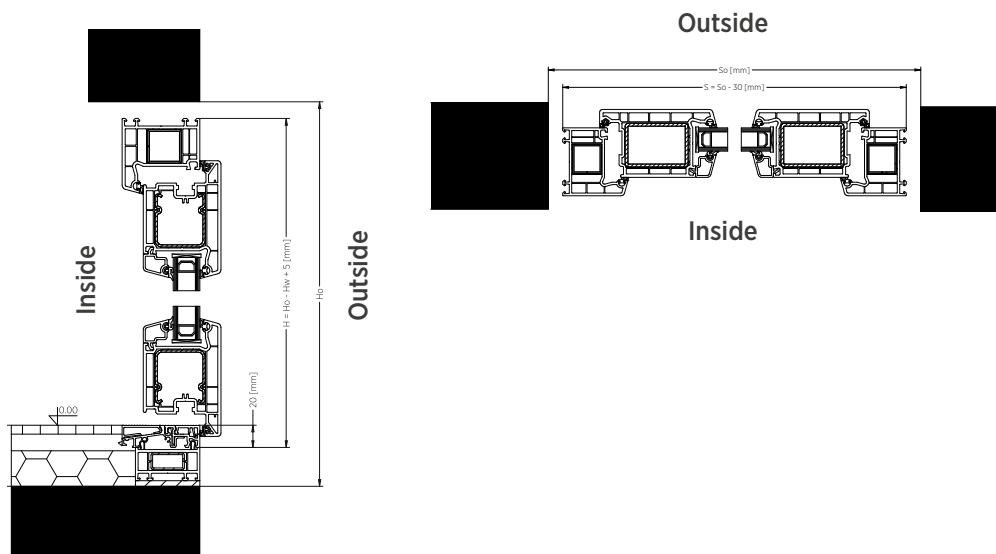

STRUCTURAL LIMITATIONS

Maximum leaf dimensions

	Profile system	Frame limitation	Additional requirement	Veranda leaf profile	Single-leaf PVC entrance door	
					White	Colour
Maximum surface area of the leaf	Perfectline 70	Frame 101.208	Leaf width up to 1,000 [mm]	Leaf 105.232	2.4 [m2]	
			Leaf 105.233			
		Frame 101.214	-	Leaf 105.232	2.31 [m2]	
			Leaf 105.233			
	Softline 82	-	-	Leaf 105.380	2.6 [m2]	
				Leaf 105.381		
Maximum width of the leaf	Perfectline 70	Frame 101.208	-	Leaf 105.232	1,124 [mm]	
			Leaf 105.233			
		Frame 101.214	-	Leaf 105.232	1,150 [mm]	
			Leaf 105.233			
	Softline 82	-	-	Leaf 105.380	1,150 [mm]	
				Leaf 105.381		



Maximum height of the leaf	Perfectline 70	Frame 101.208	-	Leaf 105.232	2,402 [mm]
				Leaf 105.233	
		Frame 101.214	-	Leaf 105.232	
				Leaf 105.233	
	Softline 82	-	-	Leaf 105.380	
				Leaf 105.381	
Maximum total weight of the leaf with glass	Perfectline 70	Frame 101.208	Leaf width up to 1,000 [mm]	Leaf 105.232	120 [kg]
				Leaf 105.233	100 [kg]
			Leaf width from 1,000 [mm]	Leaf 105.232	
				Leaf 105.233	
	Softline 82	-	-	Leaf 105.232	130 [kg]
				Leaf 105.233	
				Leaf 105.380	
				Leaf 105.381	
Leaf width to height ratio	-	-	-	-	< 1.6

Minimum leaf dimensions

	Width	Height
Minimum dimension	674 [mm]	1,921 [mm]

Minimum dimensions of a single-leaf structure

Structure type	Profile system	Frame profile	Double-leaf PVC entrance door	
			Width	Height
Structure with a low threshold	Perfectline 70	Frame 101.208	750	1,969
		Frame 101.214	776	1,982
	Softline 82	Frame 101.290	754	1,971
		Frame 101.291	774	1,981



structure with a frame profile threshold	Perfectline 70	Frame 101.208	750	1,997
		Frame 101.214	776	2,023
	Softline 82	Frame 101.290	754	2,001
		Frame 101.291	774	2,021

Maximum dimensions of a single-leaf structure

Structure type	Profile system	Frame profile	Double-leaf PVC entrance door	
			Width	Height
Structure with a low threshold	Perfectline 70	Frame 101.208	1,200	2,450
		Frame 101.214	1,252	2,463
	Softline 82	Frame 101.290	1,230	2,452
		Frame 101.291	1,250	2,462
structure with a frame profile threshold	Perfectline 70	Frame 101.208	1,126	2,478
		Frame 101.214	1,252	2,504
	Softline 82	Frame 101.290	1,230	2,482
		Frame 101.291	1,250	2,502

Minimum dimensions of a symmetrical structure with a sidelight

Structure type	Profile system	Frame profile	Single-leaf PVC entrance door		
			Width		Height
			Standard post	Wide post	
Structure with a low threshold	Perfectline 70	Frame 101.208	1,509	1,542	1,969
		Frame 101.214	1,535	1,568	1,982
	Softline 82	Frame 101.290	1,522	1,552	1,971
		Frame 101.291	1,542	1,572	1,981



Maximum dimensions of a symmetrical structure with a sidelight

Structure type	Profile system	Frame profile	Single-leaf PVC entrance door		
			Width		Height
			Standard post	Wide post	
Structure with a low threshold	Perfectline 70	Frame 101.208	2,351	2,384	2,450
		Frame 101.214	2,429	2,462	2,463
	Softline 82	Frame 101.290	2,408	2,438	2,452
		Frame 101.291	2,428	2,458	2,462
Maximum surface area of the window structure in a single frame	-	-	8.00 [m ²]		-

Minimum dimensions of a sidelight

Structure type	Profile system	Frame profile	Single-leaf PVC entrance door		
			Width		Height
			Standard post	Wide post	
Structure with a low threshold	Perfectline 70	Frame 101.208	277.5	294	1,969
		Frame 101.214	290.5	307	1,982
	Softline 82	Frame 101.290	280	295	1,971
		Frame 101.291	290	305	1,981

Maximum dimensions of a sidelight

Structure type	Profile system	Frame profile	Single-leaf PVC entrance door		
			Width		Height
			Standard post	Wide post	
Structure with a low threshold	Perfectline 70	Frame 101.208	4,000		2,450
		Frame 101.214			2,463
	Softline 82	Frame 101.290			2,452
		Frame 101.291			2,462
Maximum surface area of the window structure in a single frame	-	-	8.00 [m ²]		-



ANCHOR AND DOWEL HOLE SPACING FOR WHITE AND COLOUR PROFILES

Single-leaf veranda door

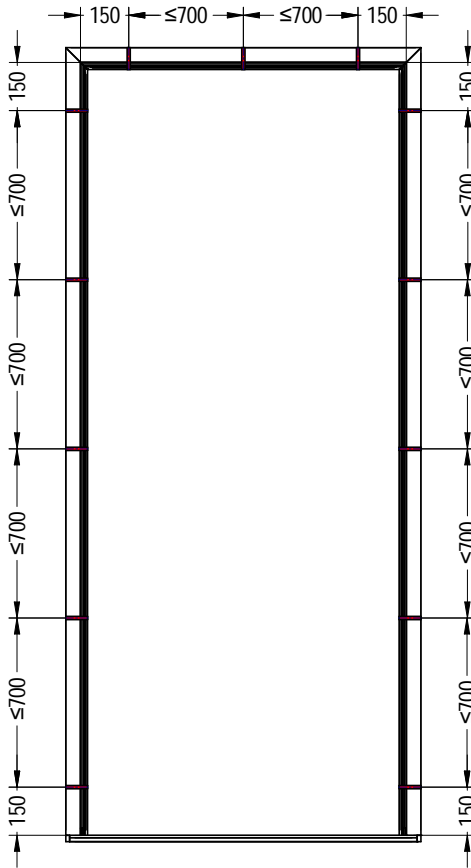

Veranda door with a sidelight

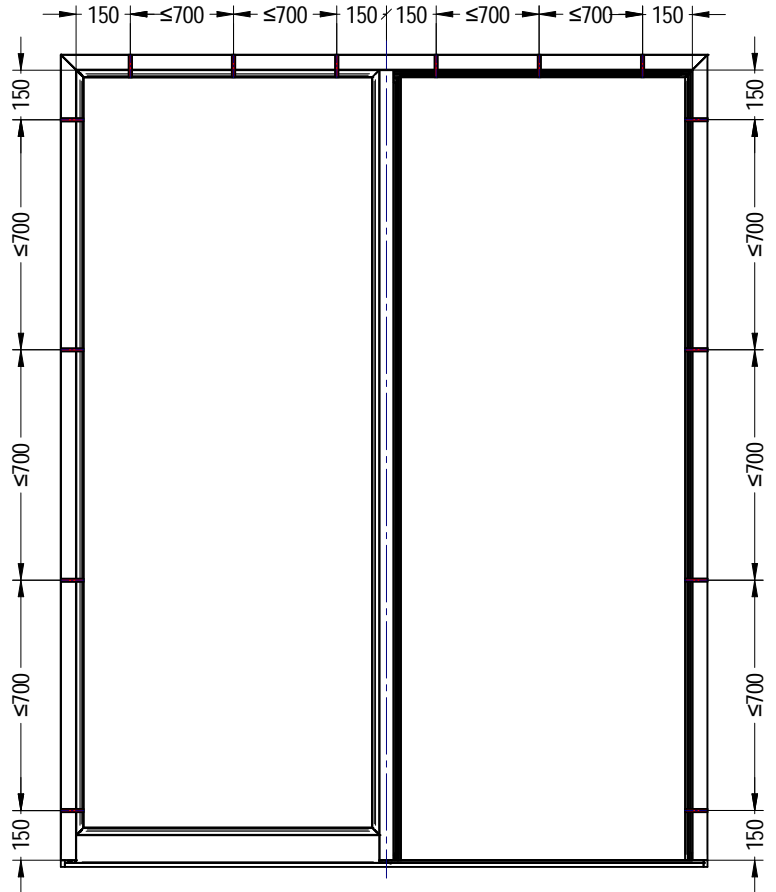









Window type	PRIMO 70 veranda	PRIMO 70 entrance	PRIMO 82 entrance
Number of chambers in the frame	5	5	7
Profile thickness	70 mm	70 mm	82 mm
Gaskets around the circumference	2	2	3
Structural reinforcement	steel box section in the frame	steel hollow section in the frame	steel hollow section in the frame
Standard glass unit	single-chamber 4/16/4 Ug=1.1 W/m ² K	single-chamber 4/16/4 Ug=1.1W/m2K	two-chamber 4/18/4/18/4 Ug=0.5W/m2K
Handle	aluminium	aluminium	aluminium
Also available in class	Security 2	Security 2	Security 2
Widening 30 mm	Yes	Yes	Yes

**WIŚNIEWSKI**

WIŚNIEWSKI Sp. z o.o. S.K.A.
 PL 33-311 Wielogłowy 153
 tel. +48 18 44 77 111
 Fax +48 18 44 77 110
www.wisniowski.eu

Let us inspire you!
 See other solutions from WIŚNIEWSKI!



The products shown in this publication often feature special accessories and do not always correspond to their standard versions • The technical data sheet does not constitute an offer within the meaning of the Polish Civil Code • The manufacturer reserves the right to introduce changes without notice • NOTE: The colours shown in the technical data sheet are for reference only • All rights reserved • Copying and use, in part or in full, is prohibited without the consent of WIŚNIEWSKI Sp. z o.o. S.K.A. • PVC doors/03.23/EN